



Keep it rolling.™

## **EUROPEAN PRO CATALOG 2024**

---

## Schumacher is driven by its commitment to innovation and the highest quality at an optimized cost.

We design and manufacture battery chargers, inverters, AGM or lithium jump starters, 12 V accessories, chargers for electric and hybrid vehicles for the retail and professional markets.

With plants in Mexico, Belgium, and China we are able to efficiently supply on a worldwide basis.

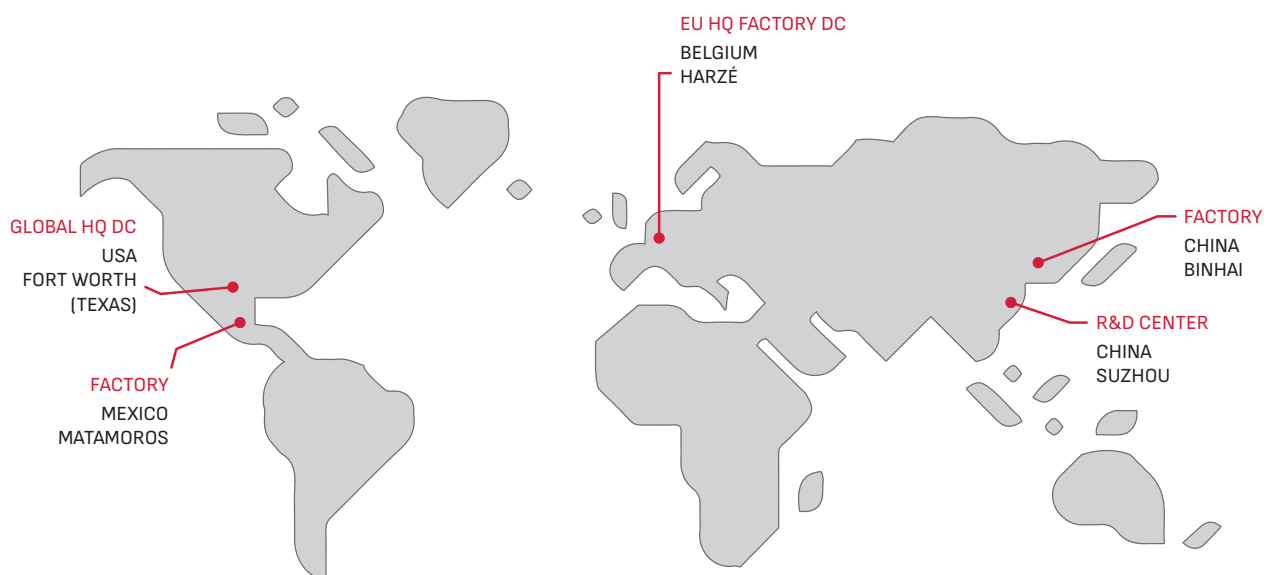

*Since*  
**1947**



Keep it rolling.™





**EV**SERIES™





ELECTRIC CHARGER  
SEV455



EV Series

Lithium  
Jump starters

AGM  
Jump starters

Electronic  
chargers

Electromechanical  
chargers

Battery testers

Worklights

**EV**SERIES™







# EV SERIES™

## SEV455



+++

Attractive design with ergonomic-designed connector

5m cable length, with a flexible cable management

Durable, weatherproof housing (IP 66)

Easy to install

Dynamic LED status

Wi-Fi

### TECHNICAL INFORMATION

MODEL	SEV455
Input	AC 220-240 V, 50-60 Hz
Rated current max	Single phase 32 Amp
Plug type	Type 2
Rated output power	7,4 kW
Wi-Fi connected	Yes
Operating temperature	-30° C to +50° C
Installation location	indoor/outdoor (IP 66)
Installation type	Hardwired*
Power wiring	3 wires single phase L, N + Ground
Cable Length	5 m cables (Type2)
Certification	CE

\* Hardwired installation requires a certified electrician and compliance with country electrical guidelines.



LITHIUM JUMP STARTER  
SL474



Worklights

Battery testers

Electromechanical  
chargers

Electronic  
chargers

AGM  
Jump starters

Lithium  
Jump starters

EV Series



# LITHIUM JUMP STARTER

SL 471 ⚡ 12 V 🔌 300 CA / 600 PA



+++

4-cell technology

LED charge level

Compact design

Sends a shock to wake up deeply discharged batteries

USB output 2,4 A

Lightweight

Powerful battery pack

Soft Touch

Built-in LED area light (3 modes)







# LITHIUM JUMP STARTER

12 V

**SL 472**  
500 CA  
1000 PA

**SL 473**  
750 CA  
1500 PA

**SL 474**  
1000 CA  
2000 PA



+++

4-cell technology

3.0 A USB Port – charge 4x faster

Carrying case

Sends a shock to wake up deeply discharged batteries

LCD Screen

Soft touch and compact design

Powerful battery pack

Built-in LED area light (3 modes)

Wireless charging



## SL RANGE



### TECHNICAL INFORMATION

MODEL	SL 471	SL 472	SL 473	SL 474
PART NUMBER	94065471	94065472	94065473	94065474
VOLTAGE	12 V	12 V	12 V	12 V
PEAK AMPS	600	1000	1500	2000
WIRELESS CHARGE	NO	10W	10W	10W
INPUT USB CHARGE	USB-C	USB-C	USB-C	USB-C
OUTPUT USB POWER	2,4 A	2,4 - 3 A	2,4 - 3 A	2,4 - 3 A
CABLE LENGTH	0,45 m	0,45 m	0,45 m	0,45 m
CABLE CROSS SECTION	5,27 mm <sup>2</sup> (10 GA)	5,27 mm <sup>2</sup> (10 GA)	5,27 mm <sup>2</sup> (10 GA)	8,37 mm <sup>2</sup> (8 GA)
LED LIGHT	YES	YES	YES	YES



### PACKAGING INFORMATION

MODEL	SL 471	SL 472	SL 473	SL 474
NET WEIGHT	0,76 kg	1,1 kg	1,2 kg	1,33 kg
DIMENSIONS ( L x W x h ) mm	202 x 112 x 73	245 x 130 x 115	245 x 130 x 115	245 x 130 x 115

### HOW TO CHOOSE

PART NUMBER	MODEL	VOLTAGE	12 V					
			<75*	120	150	165	190	275
			HP* = CHECK YOUR ENGINE HP - LEGEND: ■ NORMAL ■■ INTENSIVE					
94065471	SL 471	12 V	■					
94065472	SL 472	12 V	■■	■■	■	■		
94065473	SL 473	12 V	■■	■■	■■	■	■	
94065474	SL 474	12 V	■■	■■	■■	■■	■■	■



GIGALITHIUM ⚡ 12 V 🔌 800 CA

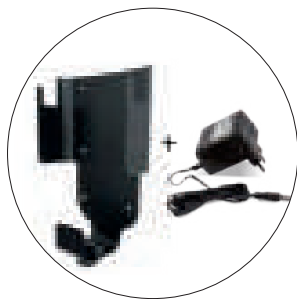

Docking station & battery charger



+++

4-cell lithium LiFePO4  
100% safe

Lightweight

LCD screen

Microprocessor controlled

Protection against  
over discharge

Protection against  
over charge

Protection against  
over temperature

Protection against  
reverse polarity

Protection against  
short circuit

Protection against  
voltage error and overload

Override mode

Memory saver







## LITHIUM JUMP STARTER

GIGALITHIUM ⚡ 12/24 V 🔌 2000/1000 CA



Docking station & battery charger



+++

4-cell lithium LiFePO4  
100% safe

Lightweight

LCD screen

Microprocessor controlled

Protection against  
over discharge

Protection against  
over charge

Protection against  
over temperature

Protection against  
reverse polarity

Protection against  
short circuit

Protection against  
voltage error and overload

Override mode

Memory saver





GIGALITHIUM 12 V



GIGALITHIUM 12/24 V

## TECHNICAL INFORMATION

MODEL	GIGALITHIUM 12 V	GIGALITHIUM 12/24 V
PART NUMBER	805600100	805600200
VOLTAGE (DC)	12 V	12/24 V
CRANKING AMPS (CA)	800	2000/1000
CABLE LENGTH	0,50 m	1,60 m
CABLE CROSS SECTION	10 mm <sup>2</sup>	25 mm <sup>2</sup>
AUTOMATIC CHARGER	1 A	4 A



## PACKAGING INFORMATION

MODEL	GIGALITHIUM 12 V	GIGALITHIUM 12/24 V
NET WEIGHT	3 kg	6,25 kg
DIMENSIONS ( L x W x h ) mm	445 x 250 x 115	400 x 345 x 210

## HOW TO CHOOSE

PART NUMBER	MODEL	VOLTAGE	12 V						24 V				
			<125*	150	175	250	300	500	100	250	500	1000	
			HP* = CHECK YOUR ENGINE HP - LEGEND: ■ NORMAL ■■ INTENSIVE										
805600100	GIGALITHIUM	12 V	■■	■■	■	■							
805600200	GIGALITHIUM	12/24 V	■■	■■	■■	■	■			■■	■■		







AGM JUMP STARTERS  
PROPULSTATION



EV Series

Lithium  
Jump starters

AGM  
Jump starters

Electronic  
chargers

Electromechanical  
chargers

Battery testers

Worklights





PBI 1812 ⚡ 12 V 🔌 700 CA



+++

ON/OFF switch eliminates shorting of clamps and battery drain

300A in-line fuse protects against excessive current output

Reverse polarity alarm

Anti-spiking protection

12 V accessory outlet also used for memory saver mode

Lightweight

Colour LEDs indicate battery level and charging status

Compact and durable casing





# AGM JUMP STARTER

PBI 200 ⚡ 12 V 🔌 900 CA



+++

ON/OFF switch eliminates shorting of clamps and battery drain

Heavy-duty curved clamps and flexible 21 mm<sup>2</sup> cables

Digital display

Reverse polarity alarm and anti-spiking protection

12 V accessory outlet also used for memory saver mode

Soft handle and protective rubbers for extra robustness

2,1 A USB output ideal for charging different types of electronic devices

300 A in-line fuse protects against excessive current output







# AGM JUMP STARTER

PBI 201 ⚡ 12/24 V 🔌 1800/900 CA



+++

ON/OFF switch eliminates shorting of clamps and battery drain

Heavy-duty curved clamps and flexible 33 mm<sup>2</sup> cables

Digital display

Reverse polarity alarm and anti-spiking protection

12 V accessory outlet also used for memory saver mode

Soft handle and protective rubbers for extra robustness

2,1 A USB output ideal for charging different types of electronic devices

500 A in-line fuse protects against excessive current output





# AGM JUMP STARTER

PBI 2400HD ⚡ 12/24 V ⚙️ 2400/1200 CA



+++

Rotomolded and unbreakable housing

Heavy-duty curved clamps and double-insulated, ultra-flexible 50mm<sup>2</sup> cable

Retractable handle and puncture-proof wheels

Reverse polarity buzzer

12 V accessory outlet also used for memory saver mode

Optional: Auxiliary connector for auxiliary cables

Anderson connectors for voltage selection (12/24 V)

500 A fuse for short-circuit protection and 1 spare fuse



# THE PBI RANGE



PBI 1812

PBI 200

PBI 201

PBI 2400 HD

## TECHNICAL INFORMATION

MODEL	PBI 1812	PBI 200	PBI 201	PBI 2400 HD
PART NUMBER	94065001C	94065200C	94065201C	232008
VOLTAGE (DC)	12 V	12 V	12/24 V	12/24 V
CRANKING AMPS (CA)	700	900	1800/900	2400/1200
CABLE LENGTH	0,71 m	1,59 m	1,70 m	1,52 m
CABLE CROSS SECTION	21 mm <sup>2</sup>	21 mm <sup>2</sup>	33 mm <sup>2</sup>	50 mm <sup>2</sup>
AUTOMATIC CHARGER	0,7 A	2 A	2 A	4 A



## PACKAGING INFORMATION

MODEL	PBI 1812	PBI 200	PBI 201	PBI 2400 HD
NET WEIGHT	9,25 kg	11,75 kg	20,8 kg	30,5 kg
DIMENSIONS ( L x W x h ) mm	330 x 170 x 363	360 x 150 x 440	425 x 230 x 455	475 x 290 x 550

## HOW TO CHOOSE

PART NUMBER	MODEL	VOLTAGE	12 V							24 V					
			<125*	150	175	250	300	350	500	100	250	500	1000	1500	2000
HP* = CHECK YOUR ENGINE HP - LEGEND: ■ NORMAL ■■ INTENSIVE															
94065001C	PBI 1812	12 V	■■	■	■										
94065200C	PBI 200	12 V	■■	■■	■	■									
94065201C	PBI 201	12/24 V	■■	■■	■■	■	■	■		■■	■■	■			
232008	PBI 2400 HD	12/24 V	■■	■■	■■	■■	■■	■■	■	■■	■■	■■	■	■	

Related Battery charger Part number:

PBI 1812

PBI 200

PBI 201

PBI 2400 HD

EU: 94065021

EU: 2299003058CZ

EU: 2299003058CZ

EU: 865124-A

UK: 94065022

UK: 2299003058GZ

UK: 2299003058GZ

UK: 865124-A + 976158



# SOSBOOST

+++

## BATTERIES

---

Our AGM batteries, with pure lead are extremely efficient thanks to their ability to deliver energy at high amperage almost instantaneously.

## FUSE

---

The fuse protects the booster battery against excessive current output and short-circuits. It is very easy to replace.



## CLAMPS

---

The clamps have been developed for convenience and ease of use with curved, wide-opening jaws. They are designed to optimize safety and performance with heavy-duty insulation and a copper bridge, which ensures easy transfer of current from both clamps.

## STARTING CABLES

---

Starting cables feature double insulation, extreme flexibility, and an optimal length. They offer superior power transfer and withstand frequent use.

## THE SOSBOOST RANGE



SOS 6 V  
850 CA

SOS 12 V  
440 CA

SOS 12 V  
700 CA

SOS 12 V  
800 CA

### TECHNICAL INFORMATION

MODEL	6 V /850 CA	12 V /440 CA	12 V /700 CA	12 V /800 CA	12 V /1000 CA
PART NUMBER	860011	861044	861001	861002	861011
VOLTAGE (DC)	6 V	12 V	12 V	12 V	12 V
CRANKING AMPS (CA)	850	440	700	800	1000
CABLE LENGTH	1,50 m	0,6 m	1,3 m	1,3 m	1,3 m
CABLE CROSS SECTION	35 mm <sup>2</sup>	25 mm <sup>2</sup>	25 mm <sup>2</sup>	25 mm <sup>2</sup>	25 mm <sup>2</sup>
AUTOMATIC CHARGER	0,8 A	1,3 A	1,3 A	2 A	2 A



### PACKAGING INFORMATION

MODEL	6 V /850 CA	12 V /440 CA	12 V /700 CA	12 V /800 CA	12 V /1000 CA
NET WEIGHT	16,5 kg	6 kg	9,5 kg	9,5 kg	11 kg
DIMENSIONS ( L x W x h ) mm	450 x 130 x 390	360 x 130 x 240	375 x 110 x 320	375 x 110 x 320	375 x 110 x 320

### HOW TO CHOOSE

PART NUMBER	MODEL	VOLTAGE	6 V							12 V		24V		
			100*	<125	150	175	250	300	350	500	100	250		
HP* = CHECK YOUR ENGINE HP - LEGEND: ■ NORMAL														
860011	6 V /850 CA	6 V	■ ■											
861044	12 V /440 CA	12 V		■	■									
861001	12 V /700 CA	12 V		■ ■	■	■								
861002	12 V /800 CA	12 V		■ ■	■ ■	■	■							
861011	12 V /1000 CA	12 V		■ ■	■ ■	■ ■	■	■						
860003	12 V /1200 CA	12 V		■ ■	■ ■	■ ■	■ ■	■	■					
761001	12/24 V 1400/700 CA	12/24 V		■ ■	■ ■	■ ■	■ ■	■	■			■ ■	■	
761006	12/24 V 1600/800 CA	12/24 V		■ ■	■ ■	■ ■	■ ■	■ ■	■			■ ■	■ ■	
231009	12/24 V 2000/1000 CA	12/24 V		■ ■	■ ■	■ ■	■ ■	■ ■	■ ■	■		■ ■	■ ■	
760008	12/24 V-2400/1200 CA	12/24 V		■ ■	■ ■	■ ■	■ ■	■ ■	■ ■	■ ■	■ ■	■ ■	■ ■	■ ■
960000	12/24 V-3200/1600 CA	12/24 V		■ ■	■ ■	■ ■	■ ■	■ ■	■ ■	■ ■	■ ■	■ ■	■ ■	■ ■













SOS 12 V 1000 CA      SOS 12 V 1200 CA      SOS 12/24 V 1400/700 CA      12/24 V 1600/800 CA      12/24 V 2000-1000 CA      12/24 V 2400/1200 CA      M 12/24 V 3200/1600 CA

12 V /1200 CA	12/24 V 1400/700 CA	12/24 V 1600/800 CA	12/24 V 2000/1000 CA	12/24 V 2400/1200 CA	M 12/24 V 3200/1600 CA
860003	761001	761006	231009	760008	960000
12 V	12/24 V	12/24 V	12/24 V	12/24 V	12/24 V
1200	1400/700	1600/800	2000/1000	2400/1200	3200/1200
1,5 m	1,35 m	1,35 m	1,70 m	1,35 m	1,95 m
35 mm <sup>2</sup>	35 mm <sup>2</sup>	35 mm <sup>2</sup>	50 mm <sup>2</sup>	50 mm <sup>2</sup>	70 mm <sup>2</sup>
2 A	4 A	4 A	4 A	4 A	7 A

12 V /1200 CA	12/24 V 1400/700 CA	12/24 V 1600/800 CA	12/24 V 2000/1000 CA	12/24 V 2400/1200 CA	M 12/24 V 3200/1600 CA
14,5 kg	20,5 kg	20,5 kg	24,4 kg	24,8 kg	55 kg
450 x 130 x 390	530 x 160 x 480	530 x 160 x 480	410 x 225 X 400	530 x 160 x 480	470 x 340 x 970

### 24V

500	1000	1500	2000
■ ■ INTENSIVE			
■			
■			
■ ■	■	■	
■ ■	■ ■	■	

OPTIONAL AUXILIARY CABLES	PART NUMBER FOR PORTABLE BOOSTERS	PART NUMBER FOR MOBILE BOOSTERS ITEM 960000
Auxiliary connector built on the booster	860014 	860022 
	860037	860035
	860016	860034
	860015	860024
	976001	976002
	976003	976004
	860032	860033

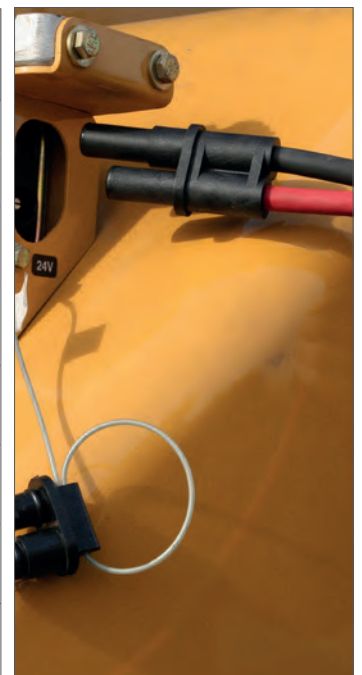

# PROPULSTATION

+++

## BATTERIES

Our AGM batteries, with pure lead are extremely efficient thanks to their ability to deliver energy at high amperage almost instantaneously.



## THE FUSE

The fuse is directly accessible from the outside of the booster. A spare fuse is available on the side of housing.

A blue LED indicates the correct functioning of the fuse. If it does not light up when pushing on the red button, the fuse is blown.

## VOLTAGE DETECTION SYSTEM AND CORRECT CONNECTION SIGNAL

An LED system indicates the voltage to select on the booster. It reduces the risk of misuse while using a 12/24 V booster. The LEDs also indicate if the booster is correctly connected to the station.

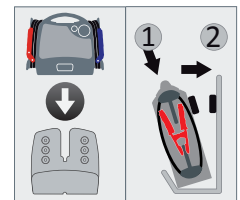

## THE CONNECTOR

It revolutionizes and makes the storing of the booster in its station easier.

Thanks to the powerful magnets, the booster is guided at its place avoiding any risk of bad connection. The connector ensures an optimal recharge of the booster and avoids any movement while stored in the vehicle.





# AGM JUMP STARTER

## PROPULSTATION ⚡ 12 V 🔌 800 CA

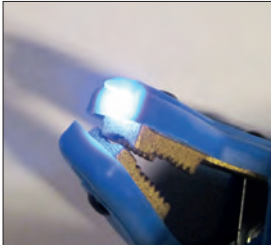

+++

Robust shell case design 5 mm shatterproof polyethylene

Long and flexible cables with a double insulation and clamps fully insulated

The battery has exceptionally high capacity to accumulate and disperse high-ampere energy

Fully insulated clamps

The connector ensures an optimal recharge of the booster

The blue clamp is fitted with an LED light to make it easier and safer to use, even in the dark

The 300 A fuse is directly accessible from the outside of the booster





# PROPULSTATION ⚡ 12 V 🔌 1200 CA

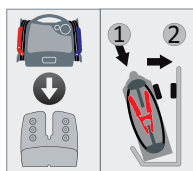

+++

Robust shell case design 5 mm shatterproof polyethylene

Long and flexible cables with a double insulation

The battery has exceptionally high capacity to accumulate and disperse high-ampere energy

The connector ensures an optimal recharge of the booster (5 magnetic poles)

Fully insulated clamps

The 500 A fuse is directly accessible from the outside of the booster







# AGM JUMP STARTER

## PROPULSTATION ⚡ 12/24 V ⚙️ 2400/1200 CA



Robust shell case design 5 mm shatterproof polyethylene

Long and flexible cables with a double insulation

The battery has exceptionally high capacity to accumulate and disperse high-amperage energy

Fully insulated clamps

LED system indicates the voltage to select on the booster

LED light ON if the booster is correctly connected to the station

The connector ensures an optimal recharge of the booster (5 magnetic poles)

The 500 A fuse is directly accessible from the outside of the booster





## AGM JUMP STARTER

PROPULSTATION ⚡ 12 V ⚡ 6400 CA



+++

For heavy-duty start-ups

Large wheels for off-road situation

Robust shell case design 5 mm shatterproof polyethylene

Equipped with an auxiliary connector for optional cable connection

Long and flexible cables with a double insulation. Also equipped with fully insulated clamps

The connector ensures an optimal recharge of the booster (5 magnetic poles)

The battery has an exceptionally high capacity to accumulate and disperse high-amperage energy

The two 500 A fuses are directly accessible from the outside of the booster







## AGM JUMP STARTER

PROPULSTATION ⚡ 12/24 V ⚙️ 3200/1600 CA



+++

For heavy-duty start-ups

Robust shell case design 5 mm shatterproof polyethylene

Long and flexible cables with a double insulation. Also equipped with fully insulated clamps

The battery has an exceptionally high capacity to accumulate and disperse high-amperage energy

Large wheels for off-road situation

Equipped with an auxiliary connector for optional cable connection

The connector ensures an optimal recharge of the booster (5 magnetic poles)

The two 500 A fuses are directly accessible from the outside of the booster







## AGM JUMP STARTER

PROPULSTATION ⚡ 24 V ⚙️ 3200 CA



+++

For heavy-duty start-ups

Robust shell case design 5 mm shatterproof polyethylene

Long and flexible cables with a double insulation. Also equipped with fully insulated clamps

The battery has an exceptionally high capacity to accumulate and disperse high-amperage energy

Large wheels for off-road situation

Equipped with an auxiliary connector for optional cable connection

The connector ensures an optimal recharge of the booster (5 magnetic poles)

The two 500 A fuses are directly accessible from the outside of the booster



# THE PROPULSTATION RANGE



## TECHNICAL INFORMATION

MODEL	PPS 12 V 800	PPS 12 V 1200	PPS 12/24 V 2400/1200	PPS 12 V 6400	PPS 12/24 V 3200/1600	PPS 24 V 3200
PART NUMBER	521002	520003	520008	560004	560000	560003
VOLTAGE (DC)	12 V	12 V	12/24 V	12 V	12/24 V	24 V
CRANKING AMPS (CA)	800 A	1200 A	2400/1200 A	6400 A	3200/1600 A	3200 A
CABLE LENGTH	1,55 m	1,55 m	1,35 m	2,10 m	2,10 m	2,10 m
CABLE CROSS SECTION	35 mm <sup>2</sup>	50 mm <sup>2</sup>	50 mm <sup>2</sup>	70 mm <sup>2</sup>	70 mm <sup>2</sup>	70 mm <sup>2</sup>



## PACKAGING INFORMATION

MODEL	PPS 12 V 800	PPS 12 V 1200	PPS 12/24 V 2400/1200	PPS 12 V 6400	PPS 12/24 V 3200/1600	PPS 24 V 3200
NET WEIGHT	13,55 kg	17,50 kg	27,90 kg	75 kg	70 kg	70 kg
DIMENSIONS (L x W x h) mm	450 x 170 x 510	450 x 170 x 510	560 x 190 x 610	580 x 510 x 1100	580 x 510 x 1100	580 x 510 x 1100

## HOW TO CHOOSE

PART NUMBER	MODEL	VOLTAGE	12 V							24 V						
			<125*	150	175	250	300	350	500	1000+	100	250	500	1000	1500	2000
			HP* = CHECK YOUR ENGINE HP - LEGEND: <span style="background-color: #cccccc;">■</span> NORMAL <span style="background-color: #333333;">■</span> INTENSIVE													
521002	PPS 800	12 V	■	■	■	■										
520003	PPS 1200	12 V	■	■	■	■	■	■								
520008	PPS 2400/1200	12/24 V	■	■	■	■	■	■	■	■	■	■	■	■		
560004	PPS 6400	12 V	■	■	■	■	■	■	■	■	■					
560000	PPS 3200/1600	12/24 V	■	■	■	■	■	■	■	■	■	■	■	■	■	
560003	PPS 3200	24V										■	■	■	■	■

### RELATED PART NUMBER:

#### DOCKING STATION

- DC Vehicle station - with DC cable
- AC Workshop station - with charger AC/DC-230/12V

#### BATTERY CHARGER FOR DOCKING STATION AC

PPS 12 V	PPS 12/24 V	12 V Mobile	12/24 V Mobile	24 V Mobile
DC12	DC1224	DCM		
AC12	AC1224	ACM	ACM	ACM
12 V-2 A PN: 522502	12 V-3 A PN: 522504	12 V-10 A PN: 522510	12 V-7 A PN: 522507	12 V-10 A PN: 522510



# PROPULSTATION ⚡ 72 V – Locomotive



+++

The highest voltage boosters on the market

Robust shell case design 5 mm shatterproof polyethylene

Long and flexible cables with a double insulation

Fully insulated clamps

The battery has exceptionally high capacity to accumulate and disperse high-amperage energy

Two 500 A fuses protect the batteries against short-circuits and overheating





** TECHNICAL INFORMATION**

MODEL	PPS 72 V	PPS 110 V
PART NUMBER	560020	561023
VOLTAGE (DC)	72 V	110 V
QUANTITY OF BATTERIES	6 X 12 V	9 x 12 V
BATTERY PROTECTION FUSES	2 x 500 A	2 x 300 A
CABLE LENGTH	5 m	2 m
CABLE CROSS SECTION	70 mm <sup>2</sup>	70 mm <sup>2</sup>

** PACKAGING INFORMATION**

MODEL	560020	561023
NET WEIGHT	90,2 kg	55 kg
DIMENSIONS ( L x W x h ) mm	500 x 540 x 1100	500 x 540 x 1100





ELECTRONIC CHARGER  
SPI



EV Series

Lithium  
Jump starters

AGM  
Jump starters

Electronic  
chargers

Electromechanical  
chargers

Battery testers

Worklights





# ELECTRONIC CHARGERS

SPI1 ⚡ 6/12 V ↻ 1 A



+++

- Battery charger and maintainer

---

- For 6 and 12 V batteries up to 32 Ah

---

- Microprocessor controlled

---

- Protection against: Reverse polarity, spark proof and thermal runaway

- AGM, Standard, Gel, Calcium, Start n' Stop

---

- Charging status LED

---

- Protective bumpers and hook attachment

---

- Fully automatic and safety shut-off





# ELECTRONIC CHARGERS

SPI2 ⚡ 6/12 V ↗ 2 A



+++

- |   |  |
|---|--|
| Battery charger and maintainer  | AGM, Standard, Gel, Calcium, Start n' Stop |
| For 6 and 12 V batteries up to 46 Ah                                  | Charging status LED                        |
| Microprocessor controlled   | Protective bumpers & hook attachment       |
| Protection against: Reverse polarity, spark proof and thermal runaway | Fully automatic and safety shut-off        |







## ELECTRONIC CHARGERS

SPI3 ⚡ 12 V 🔌 3 A



+++

100% automatic battery charger and maintainer with safety shut-off

AGM, Standard, gel, calcium, Start n' Stop, Lithium (LiFePO4)

For 12 V batteries up to 58 Ah

Compatible lithium LiFePO4

Microprocessor controlled and multi-stage charging

Protective bumpers and hook attachment

Protection against: Reverse polarity, spark proof and thermal runaway

Scrolling digital display featuring English, German, French







# ELECTRONIC CHARGERS

SPI6 ⚡ 12 V 🔌 6 A



+++

100% automatic battery charger and maintainer with safety shut-off

AGM, Standard, gel, calcium, Start n' Stop

For 12 V batteries up to 130 Ah

Charging status LED

Microprocessor controlled and multi-stage charging

Protective bumpers and hook attachment

Protection against: Reverse polarity, spark proof and thermal runaway

Scrolling digital display featuring English, German, French, Italian, Spanish





# ELECTRONIC CHARGERS

SPI10 ⚡ 12 V 🔌 10 A



+++

100% automatic battery charger and maintainer with safety shut-off

AGM, Standard, gel, calcium, Start n' Stop

For 12 V batteries up to 200 Ah

Charging status LED

Microprocessor controlled and multi-stage charging

Scrolling digital display featuring, English, German, French, Italian, Spanish

Protection against: Reverse polarity, spark proof and thermal runaway

Protective bumpers and hook attachment







## ELECTRONIC CHARGERS

SPI15 ⚡ 12 V 🔌 15 A – Showroom mode



+++

100% automatic battery charger and maintainer with safety shut-off

For 12 V batteries up to 230 Ah

Microprocessor controlled and multi-stage charging

Protection against: Reverse polarity, spark proof and thermal runaway

AGM, Standard, gel, calcium, Start n' Stop

Showroom mode: Supply of constant current

Protective bumpers and hook attachment

Scrolling digital display featuring, English, German, French, Italian, Spanish







## ELECTRONIC CHARGERS

SPI1224 ⚡ 12/24 V 🔌 15/10 A



+++

For 12 V or 24 V batteries up to 230 Ah

Microprocessor controlled and multi-stage charging

Protection against: Reverse polarity, spark proof and thermal runaway. Safety shut-off and ventilation system

AGM, gel, calcium, Start n' Stop

Charging status Led

Hook attachment and protective bumpers

Scrolling digital display featuring English, German, French

Recovery mode for sulphated batteries for 12 and 24 V



# THE SPI RANGE



## TECHNICAL INFORMATION

MODEL	SPI1	SPI2	SPI3	SPI6	SPI10	SPI15	SPI1224
PART NUMBER	94065104*	94065049*	94065050*	94065091*	94065092*	94065189*	94065194*
	* Add letter plug type PLUG EU = C PLUG UK = G PLUG AU = I						
OUTPUT VOLTAGE (DC)	6/12 V	6/12 V	12 V	12 V	12 V	12 V	12/24 V
NOMINAL AC VOLTAGE	230V AC - 50 Hz						
MAX. CHARGING CURRENT	1 A	2 A	3 A	6 A	10 A	15 A	15/10 A
IP RATING	IP54	IP54	IP54	IP20	IP20	IP20	IP20
BATTERY TYPE	Lead-Acid	Lead-Acid	Lead-Acid & Lithium	Lead-Acid	Lead-Acid	Lead-Acid	Lead-Acid
OUTPUT CABLE (CM) (FROM ENCLOSURE TO CLAMP END)	201	185	185	218	218	185	185
WORKING TEMPERATURE	-20° to +50° C						



## PACKAGING INFORMATION

MODEL	SPI1	SPI2	SPI3	SPI6	SPI10	SPI15	SPI1224
NET WEIGHT	0,6 kg	1 kg	1 kg	1,4 kg	1,4 kg	1,7 kg	1,7 kg
DIMENSIONS (L x W x h) mm	195 x 148 x 65	189 x 210 x 77	189 x 210 x 77	208 x 83 x 239	208 x 83 x 239	228 x 102 x 244	228 x 102 x 244

## HOW TO CHOOSE

PART NUMBER	MODEL	VOLTAGE	6 V		12 V							24 V			
			12 Ah		32 Ah	46 Ah	58 Ah	130 Ah	165 Ah	200 Ah	230 Ah	230 Ah	360 Ah	550 Ah	
94065104	SPI1	6/12 V	■		■										
94065049	SPI2	6/12 V	■		■	■									
94065050	SPI3	12 V			■	■	■								
94065091	SPI6	12 V			■	■	■	■							
94065092	SPI10	12 V			■	■	■	■	■	■					
94065189	SPI15	12 V			■	■	■	■	■	■	■				
94065194	SPI1224	12/24 V			■	■	■	■	■	■	■	■			



# SPI16 PRO ⚡ 12/24 V ⚡ 16/8 A



+++

Showroom mode

---

GEL - WET - AGM - VRLA - MF - DRY - Start'n Stop

---

Compatible lithium LiFePO4

---

Charge amperage selection

Power supply - Memory saver

---

ADAS supply

---

Recovery mode

---

Standard accessories: clamps and eyelets







**ELECTRONIC CHARGERS**

SPI25 PRO ⚡ 12/24 V 🔌 25/12,5 A



+++

Showroom mode

GEL - WET - AGM - VRLA - MF - DRY - Start'n Stop

Compatible lithium LiFePO4

Charge amperage selection

Power supply - Memory saver

ADAS supply

Recovery mode

Standard accessories: clamps



# THE SPI PRO RANGE



SPI16 PRO

SPI25 PRO

## TECHNICAL INFORMATION

MODEL	SPI16 PRO	SPI25 PRO
PART NUMBER EUROPE	809030	809040
PART NUMBER AUSTRALIA	94065316I	94065325I
VOLTAGE (DC)	12 V - 24 V	12 V - 24 V
NOMINAL AC VOLTAGE	230V AC - 50 Hz	230V AC - 50 Hz
INPUT POWER	280 W	450 W
RATED CURRENT (MIN-MAX)	4 - 8 -16 A	5 - 12,5 - 25 A
CHARGING AND TESTING STAGES	9	9
CHARGE CAPACITY	5 Ah - 360 Ah	5 Ah - 550 Ah
MAINTENANCE CAPACITY	5 Ah - 550 Ah	5 Ah - 800 Ah
SHOWROOM FUNCTION	13,8 V - 13 A	13,8 V - 21 A
IP RATING	IP20	IP20
WORKING TEMPERATURE	-20° to +50° C	-20° to +50° C



## PACKAGING INFORMATION

MODEL	SPI16 PRO	SPI25 PRO
NET WEIGHT	2 kg	2,50 kg
DIMENSIONS ( L x W x h ) mm	260 x 130 x 75	260 x 130 x 75

## HOW TO CHOOSE

PART NUMBER	MODEL	VOLTAGE	6 V	12 V					24 V				
			12 Ah	32 Ah	46 Ah	58 Ah	130 Ah	165 Ah	200 Ah	230 Ah	230 Ah	360 Ah	550 Ah
809030	SPI 16 PRO	12/24 V		■	■	■	■	■	■	■	■		
809040	SPI 25 PRO	12/24 V		■	■	■	■	■	■	■	■	■	



# ELECTRONIC CHARGERS

2 BANK ⚡ 12 V ↗ 15 A



+++

Automatically detects connected batteries

AGM, Standard, Gel, Calcium, Start n' Stop

Automatic recovery

Protection against reverse polarity

Charge batteries sequentially

Microprocessor controlled





 TECHNICAL INFORMATION

MODEL	SC348
PART NUMBER	94065348C
VOLTAGE (DC)	12 V
NOMINAL AC VOLTAGE	230V AC - 50 Hz
MAX. CHARGING CURRENT	15 A
IP RATING	IP 65
BATTERY TYPE	Compatible with standard, AGM, gel, and deep-cycle batteries
OUTPUT CABLE (CM) (FROM ENCLOSURE TO CLAMP END)	180 cm
WORKING TEMPERATURE	-20° to +50° C





INC 100 ⚡ 12V 🔌 70A



+++

Fully automatic microprocessor-controlled charger

Lead-acid, calcium, AGM, Start 'n Stop, GEL Cell battery types

Built-in digital voltmeter/tester – shows battery voltage and charging percentage

5 – Meter cables equipped with heavy-duty clamps and Anderson connector (included)

Recovery mode for deeply discharged and sulphated batteries included

Short-circuit and thermal runaway protection

Adjustable mounting brackets for permanent installation to most vehicle lifts

Dual temperature controlled cooling fans

Heavy-duty clamps with replaceable jaws. Durable aluminium case and large carry handle

Supply 100 A peak for 3 min





INC-100

**TECHNICAL INFORMATION**

<b>MODEL</b>	INC-100
<b>PART NUMBER EU</b>	94065033
	* Add letter plug type PLUG EU = C PLUG UK = G PLUG AU = I
<b>BATTERY CHARGER</b>	
VARIABLE CHARGE RATES	4 A / 20 A / 70 A
INPUT VOLTAGE	220-240 V, 50-60 Hz
INPUT POWER	1800 W
BATTERY CAPACITY CHARGE	5-1000 Ah
MANUAL MODE WITH DIGITAL TIMER	√
BATTERY TYPE	Lead-acid, calcium, AGM, START & STOP, GEL Cell battery types
RECOVERY / DESULFATION MODE INCLUDED	√
<b>POWER SUPPLY</b>	
CONTINUOUS OUTPUT CURRENT	70 A - 100 A for 3 minutes
CONSTANT VOLTAGE OUTPUT	Selectable from 13.0 V up to 14.8 V



**PACKAGING INFORMATION**

<b>MODEL</b>	INC-100
<b>NET WEIGHT</b>	11,30 kg
<b>DIMENSIONS ( L x W x h ) mm</b>	460 x 445 x 150

RELATED PART NUMBER INC-100:

POWER CORD	5M - 34 mm <sup>2</sup> (standard)	3M - 21 mm <sup>2</sup>
EU: 90026395	Grey connector & clamps	Grey connector & clamps
UK: 90026403	EU & UK: 2299002862	EU & UK: 2299003103





## ELECTRONIC CHARGERS

FLASHMEM 60 ⚡ 12 V 🔌 60 A



+++

Microprocessor-controlled

Reprogramming, flashing and car diagnostics

Selectable output voltage up to 14.8V

Protection against reverse polarity and short circuit

Protection against voltage error and overload

Supply permanent, stabilized high Amp current

Heavy-duty clamps

WET, AGM, LITHIUM LiFePO<sub>4</sub>





**ELECTRONIC CHARGERS**

**FLASHMEM 100** ⚡ 12 V 🔌 100 A



+++

- Microprocessor-controlled

---

- Reprogramming, flashing and car diagnostics

---

- Selectable output voltage up to 14.8V

---

- Protection against reverse polarity and short circuit

- Protection against voltage error and overload

---

- Supply permanent, stabilized high Amp current

---

- Heavy-duty clamps

---

- WET, AGM, LITHIUM LiFePO4





# ELECTRONIC CHARGERS

FLASHMEM 120 ⚡ 12 V ⏚ 120 A



+++

Microprocessor-controlled

Reprogramming, flashing and car diagnostics, desulphation recovery

Selectable output voltage up to 14.8V

Protection against reverse polarity and short circuit

Protection against voltage error and overload

Supply permanent, stabilized high Amp current

Heavy-duty clamps

WET, AGM, LITHIUM LiFePO4





## THE FLASHMEM RANGE



FLASHMEM 60



FLASHMEM 100



FLASHMEM 120

### TECHNICAL INFORMATION

MODEL	FLASHMEM 60	FLASHMEM 100	FLASHMEM 120
PART NUMBER	805650300	805650400	805650500
INPUT VOLTAGE	110-240 V, 50-60 Hz		
INPUT POWER	1100 W	1700 W	2100 W
OUTPUT VOLTAGE	12 V - 14,8 V	12 V - 14,8 V	12 V - 14,8 V
CHARGE CURRENT	5-60 A	10-100 A	10-120 A
CHARGE CAPACITY	5-600 Ah	10-1000 Ah	10-1200 Ah
MAINTENANCE CAPACITY	5-1800 Ah	10-3000 Ah	10-3600 Ah
CABLE LENGTH	2,50 m	2,50 m	2,50 m
	6,00 m (805650301)	6,00 m (805650401)	6,00 m (805650501)



### PACKAGING INFORMATION

MODEL	FLASHMEM 60	FLASHMEM 100	FLASHMEM 120
NET WEIGHT	6,40 kg	8,20 kg	11,80 kg
DIMENSIONS ( L x W x h ) mm	400 x 340 x 215	440 x 375 x 240	440 x 375 x 240



MODEL	TROLLEY BM 200
PART NUMBER	895900100
NET WEIGHT	25,50 kg
DIMENSIONS ( L x W x h ) mm	540 x 560 x 1120



EV Series

Lithium  
Jump starters

AGM  
Jump starters

Electronic  
chargers

Electromechanical  
chargers

Battery testers

Worklights





## ELECTROMECHANICAL CHARGERS

SCI90 ⚡ 6/12V 🔌 3 / 5 / 20 A



+++

Fully automatic microprocessor-controlled charger

Auto voltage detection (6/12 V)

150A boost mode to help start dead batteries

Deep desulfation mode

Built-in digital voltmeter/tester – shows battery voltage & charging percentage

Float mode monitoring maintains optimum battery charge

Patented thermal runaway protection, monitors charge process to prevent battery from over heating

Reverse hook-up protection  
Helps protect battery and charger from damage

Protection against reverse polarity

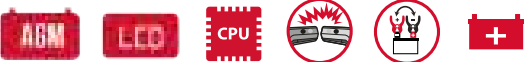



**i TECHNICAL INFORMATION**

MODEL	SCI90
PART NUMBER	94065007C
VOLTAGE (DC)	6/ 12 V
INPUT VOLTAGE	230 V AC, 50-60 Hz
INPUT POWER	1400 W
VARIABLE CHARGE RATES	3 A / 5 A / 20 A
MAX. OUTPUT CURRENT ( During 3 sec )	90 A - 150 A
ENGINE START MODE (EMERGENCY STARTING)	√
CABLE LENGTH	1,75 m
BATTERY TYPES	AGM, GEL , CALCIUM and sulfated batteries



**📦 PACKAGING INFORMATION**

MODEL	SCI90
NET WEIGHT	5,82 kg
DIMENSIONS ( L x W x h ) mm	232 x 258 x 171

RELATED PART NUMBER:

FOOT FOR RUBBER BASE

4999000171



# TITAN 60 ⚡ 12/24 V ↕ 40 A

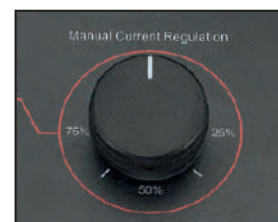

+++

3 programmed charge cycles and a manual cycle

Sulfate deposit removal and Recovery

Built-in electronic protection

10 phases of charge cycle

Constant analysis

Ideal for Start n' Stop and Spiral batteries

Potentiometer for regulating the charge current

Supply Function

Specific charge processes WET - SPIRAL/GEL-AGM

Electronic control system

Dual voltage 12/24 V





# TITAN 75 ⚡ 12/24 V ⚡ 50 A



+++

3 programmed charge cycles and a manual cycle

Sulfate deposit removal and Recovery

Built-in electronic protection

10 phases of charge cycle

Constant analysis

Ideal for Start n' Stop and Spiral batteries

Potentiometer for regulating the charge current

Supply Function

Specific charge processes WET - SPIRAL/GEL-AGM

Electronic control system

Dual voltage 12/24 V







# TITAN 100 ⚡ 12/24 V ⚙️ 70 A



+++

3 programmed charge cycles and a manual cycle

10 phases of charge cycle

Potentiometer for regulating the charge current

Electronic control system

Sulfate deposit removal and Recovery

Constant analysis

Supply Function

Dual voltage 12/24 V

Built-in electronic protection

Ideal for Start n' Stop and Spiral batteries

Specific charge processes WET - SPIRAL/GEL-AGM

Remote control for start engine mode



## THE TITAN RANGE



TITAN 60

TITAN 75

TITAN 100

### TECHNICAL INFORMATION

MODEL	TITAN 60		TITAN 75		TITAN 100	
PART NUMBER	815701300		815701400		815701500	
	* Add letter plug type PLUG EU = C PLUG UK = G PLUG AU = I					
INPUT VOLTAGE	230 V AC, 50-60 Hz					
INPUT POWER	START	60 - 8 kW	START	75 - 10 kW	START	100 - 14 kW
	CHARGE	60 - 1400 W	CHARGE	75 - 1800 W	CHARGE	100 - 2400 W
OUTPUT VOLTAGE (DC)	12/24 V		12/24 V		12/24 V	
CHARGE CURRENT	1A ▶ 40 A (60 A - Eff.)		1A ▶ 50 A (75 A - Eff.)		1A ▶ 70 A (100 A - Eff.)	
STARTING CURRENT	350 PA - 250 CA		400 PA - 300 CA		650 PA - 450 CA	
COMPATIBLE BATTERIES	PB - WET - GEL - AGM SPIRAL - MF - VRLA		PB - WET - GEL - AGM SPIRAL - MF - VRLA		PB - WET - GEL - AGM SPIRAL - MF - VRLA	
RECHARGE CAPACITY	4-450 Ah		4-550 Ah		4-700 Ah	

### PACKAGING INFORMATION

MODEL	TITAN 60	TITAN 75	TITAN 100
NET WEIGHT	18 kg	22 kg	28 kg
DIMENSIONS ( L x W x h ) mm	600 x 275 x 305	760 x 300 x 370	760 x 300 x 370







MEMORY SAVER  
OBDL



EV Series

Lithium  
Jump starters

AGM  
Jump starters

Electronic  
chargers

Electromechanical  
chargers

Battery testers

Worklights





# BATTERY TESTER

## BT175

+++

Digital Tester for 12 V batteries and starting/charging systems

For Lead-Acid, VRLA, AGM and Gel Batteries

Digital display shows voltage and CCA rating



### TECHNICAL INFORMATION

MODEL	<b>BT175</b>
PART NUMBER	940261128
VOLTAGE	7-15 V
OPERATING RANGE	100-1200CCA (SAE)



### PACKAGING INFORMATION

MODEL	<b>BT175</b>
NET WEIGHT	0,25 KG
DIMENSIONS ( L x W x h ) mm	70 X 120 X 15



# ACCUTEST ⚡ 12 V



+++

Battery tester function 12 V

Shockproof casing

Starter tester function 12 V

Intuitive multi-language menu

Blow molded plastic case

USB port and cable

Backlit LCD graphic display

Pb WET - EFB - AGM - GEL - VRLA - Start 'n Stop







# BATTERY TESTERS

## ACCUTEST+ ⚡ 12/24 V



+++

Battery tester function 12 V

Smart alternator test 12/24 V

Vehicle mass voltage drop test

Large backlit display

Rugged and shockproof casing and carry case

USB port

Printer equipped

Pb WET - GEL - AGM - MF - VRLA - SLI  
Start 'n Stop





ACCUTEST 12 V    ACCUTEST+ 12/24 V

**TECHNICAL INFORMATION**

MODEL	ACCUTEST 12 V	ACCUTEST 12/24 V
PART NUMBER	825900200	825900300
OPERATING RANGE	40 ~ 2000 CCA automotive	40 ~ 600 CCA moto / 100 ~ 2000 CCA automotive
STANDARDS	CCA/ SAE, DIN, EN1, EN2, CA/MA, IEC, JIS	CCA,SAE, DIN,EN, IEC - JIS > Yuasa Battery
BATTERY RATING	Pb WET - GEL - AGM - MF - VRLA - SLI	Pb WET - GEL - AGM - MF - VRLA - SLI
OPERATING VOLTAGE	9 - 15 V	9 - 36 V
DISPLAY	Backlit LCD	Large backlit LCD
HEAT PRINTER	No	Included
CABLE LENGTH	1,70 m	1,80 m
LANGUAGES	Pictogram display	English, Italian, French, German, Spanish, Polish,Romanian, Dutch, Swedish, Finnish
SUPPLY RANGE	9 - 15V DC	9 - 36 V DC
PACKAGING	Blow molded plastic case	Rugged and shockproof casing



**PACKAGING INFORMATION**

MODEL	ACCUTEST 12 V	ACCUTEST 12/24 V
NET WEIGHT	1,4 kg	3 kg
DIMENSIONS ( L x W x h ) mm	270 x 220 x 70	440 x 325 x 110



## MEMORY SAVER

### OBD-L Memory saver detector cable



+++

Fully automatic

Works on all vehicles equipped with a standard on-board data (OBDII) Port

Standard fuse protected auxiliary input plug

LED indication

Easy to follow 3-step instructions

Detects automatically if the vehicle's electronics will allow this device to save on-board data





## TECHNICAL INFORMATION

MODEL	OBD-L
PART NUMBER	940261086
CABLE LENGTH - CASING / CIGARETTE LIGHTER (MM)	960
CABLE LENGTH - CASING / OBDII PLUG (MM)	925
DIMENSIONS (L X W X H / MM)	140 x 70 x 40



## PACKAGING INFORMATION

MODEL	OBD-L
NET WEIGHT	0,35 kg
DIMENSIONS ( L x W x h ) mm	180 x 130 x 75



### Save the settings of your vehicle while disconnecting and replacing the battery.

Attach the OBD-L between a portable Schumacher power unit and the vehicle OBDII diagnostic port. This allows to maintain power to the vehicle on-board devices when the vehicle battery is disconnected for service or replacement. Fully automatic and user-friendly. Works on all vehicles equipped with a standard OBDII port. Colour LED indicate if the connection on both sides is OK, and if it is safe to disconnect the battery.

WORKLIGHT  
SL 184



WORKLIGHT  
SL 176

Worklights

Battery testers

Electromechanical  
chargers

Electronic  
chargers

AGM  
Jump starters

Lithium  
Jump starters

EV Series







## WORKLIGHTS

### SL 184 – SLIM 360°



+++

Li-ion 2600 mAh battery

600 lumens – 90 min Life

16 Superbright SMD LED

Soft touch rubberized casing

Adjustable rotary switch – up to 600 lumens

Unique 360° swivel and tilt function

Magnetic base

Retractable hook





**WORKLIGHTS**

**SL 360 - 400 LUMENS**



+++

Li-ion 2600 mAh battery

600 lumens - 120 min Life

16 Superbright SMD LED

Soft touch rubberized casing

Adjustable rotary switch - up to 600 lumens

Unique 360° swivel and tilt function

Magnetic base

Retractable hook





## WORKLIGHTS

### SL 886U – FLOOD LIGHT



+++

Li-ion 3.7 V 2600 mAh Battery

Magnetic Base

600 lumens – 300 min Life

Adjustable swivel hook

Aluminum and ABS housing

Supplied with Micro-USB cable







# WORKLIGHTS

## SL 176 - UNDERHOOD WORKLIGHT



+++

Li-ion 2600 mAh battery

Die-cast aluminium housing with durable ABS

400 lumens low - 1000 lumens high

COB covered with polycarbonate lens to protect user's eyes. 40° angle adjustable lamp heads

3 super-bright 5W COB LED

LED Power indicator for battery charge level

Foam covered handles won't mark the paint (adjustable length 119 to 175 cm)

60° beam angle





SL 184

SL 360

SL 886 U

SL 176

**TECHNICAL INFORMATION**

MODEL	SL 184	SL 360	SL 886U	SL 176
PART NUMBER	140010RU	140003RU	94500886	140008
LUMENS	600	200/400	300/600	400/1000
OPERATING TIME HIGH/LOW/TORCH	90 Min	360 Min / 180 Min	180 Min / 90 Min	/
TECHNOLOGY	16 SMD	10 SMD	/	15 W COB
LITHIUM - ION BATTERY CAPACITY	2600 mAh	2200 mAh	2600 mAh	2600 mAh
360 °	√	√	√	/
SOFT-TOUCH	√	√	√	/
MAGNET	1	3	1	/
HOOK ATTACHMENT	1	2	1	Foam covered handles
IP RATING	IP 54	IP 54	/	/









Keep it rolling.™

[www.schumachereurope.com](http://www.schumachereurope.com)

Schumacher Europe

Rue de la Baronnerie, 3

4920 Harzé, Belgium

[Info-be@schumacherelectric.com](mailto:Info-be@schumacherelectric.com)

+32 4 388 20 17



[@schumacherboosters](https://www.instagram.com/schumacherboosters)