

AGM JUMP STARTER

PROPULSTATION ⚡ 12 V 🔌 1200 CA

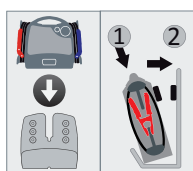

+++

Robust shell case design 5 mm shatterproof polyethylene

Long and flexible cables with a double insulation

The battery has exceptionally high capacity to accumulate and disperse high-amperage energy

The connector ensures an optimal recharge of the booster (5 magnetic poles)

Fully insulated clamps

The 500 A fuse is directly accessible from the outside of the booster



THE PROPULSTATION RANGE



PPS 12V
800 CA



PPS 12V
1200 CA



PPS 12/24V
2400/1200 CA



PPS 12V
6400 CA



PPS 12/24V
3200/1600 CA



PPS 24V
3200 CA

TECHNICAL INFORMATION

MODEL	PPS 12 V 800	PPS 12 V 1200	PPS 12/24 V 2400/1200	PPS 12 V 6400	PPS 12/24 V 3200/1600	PPS 24 V 3200
PART NUMBER	521002	520003	520008	560004	560000	560003
VOLTAGE (DC)	12 V	12 V	12/24 V	12 V	12/24 V	24 V
CRANKING AMPS (CA)	800 A	1200 A	2400/1200 A	6400 A	3200/1600 A	3200 A
CABLE LENGTH	1,55 m	1,55 m	1,35 m	2,10 m	2,10 m	2,10 m
CABLE CROSS SECTION	35 mm ²	50 mm ²	50 mm ²	70 mm ²	70 mm ²	70 mm ²



PACKAGING INFORMATION

MODEL	PPS 12 V 800	PPS 12 V 1200	PPS 12/24 V 2400/1200	PPS 12 V 6400	PPS 12/24 V 3200/1600	PPS 24 V 3200
NET WEIGHT	13,55 kg	17,50 kg	27,90 kg	75 kg	70 kg	70 kg
DIMENSIONS (L x W x h) mm	450 x 170 x 510	450 x 170 x 510	560 x 190 x 610	580 x 510 x 1100	580 x 510 x 1100	580 x 510 x 1100

HOW TO CHOOSE

PART NUMBER	MODEL	VOLTAGE	12 V								24 V					
			<125*	150	175	250	300	350	500	1000+	100	250	500	1000	1500	2000
			HP* = CHECK YOUR ENGINE HP - LEGEND: ■ NORMAL ■ INTENSIVE													
521002	PPS 800	12 V	■	■	■	■										
520003	PPS 1200	12 V	■	■	■	■	■	■								
520008	PPS 2400/1200	12/24 V	■	■	■	■	■	■	■	■	■	■	■	■	■	
560004	PPS 6400	12 V	■	■	■	■	■	■	■	■	■					
560000	PPS 3200/1600	12/24 V	■	■	■	■	■	■	■	■	■	■	■	■	■	
560003	PPS 3200	24V										■	■	■	■	

RELATED PART NUMBER:

DOCKING STATION

DC Vehicle station - with DC cable

AC Workshop station - with charger AC/DC-230/12V

BATTERY CHARGER FOR DOCKING STATION AC

PPS 12V	PPS 12/24 V	12V Mobile	12/24 V Mobile	24 V Mobile
DC12	DC1224	DCM		
AC12	AC1224	ACM		
12V-2 A PN: 522502	12V-3 A PN: 522504	12V-10 A PN: 522510	12V-7 A PN: 522507	12V-10 A PN: 845120-A